



SEDONA BY LYNX™ SERIES

# CONTEMPORARY GRAY ISLAND PACKAGE

WITH 30" SEDONA GRILL (L1500C)



*The L1500C island includes:*

30" Sedona Grill (L500PS)  
20" Refrigerator (L500REF)  
Single Side Burner (LSB501)  
Double Doors (LDR530)

**NOTE: Must Specify Gas Type – NG for Natural Gas or LP for Propane**

## L1500C PRODUCT OVERVIEW

- Complete preparation—includes a 30" Sedona Grill (L500PS), 20" Refrigerator (L500REF), Single Side Burner (LSB501), and Double Doors (LDR530)
- Weather-ready—built with premium outdoor-rated materials
- Technical convenience—two USB charging ports
- Adjustable stability—leveling feet adapt for your placement
- Lasting quality—finished with an acrylic stucco that is waterproof, UV-resistant, and long-lasting (sealed porcelain tile is frost-proof and designed for outdoor durability)
- Firmly framed—welded frame uses 1-inch square galvanized tubing
- Insightful safety—pre-wired GFI protection for the grill and refrigerator connections, with a convenient outlet for the rotisserie motor
- Quick connections—comes ready for gas connections and includes required venting
- Reliable power—runs on 110V electricity
- Simple elegance—beautiful cross-hatch pattern with a 3-inch border and 3-inch vertical lip



FOR A COMPLIMENTARY CUSTOM DESIGN FOR YOUR OUTDOOR KITCHEN, VISIT [LYNXGRILLS.COM/DESIGN-CENTER](http://LYNXGRILLS.COM/DESIGN-CENTER)

## L1500C PRODUCT FEATURES

The Sedona by Lynx™ Series full island packages are ready to create your kitchen—they include all of the sensational Lynx products you'll need to summon a complete outdoor kitchen experience, from start to beautiful stainless steel finish.

Simply select a full package, and soon you will have a stunning island that is set with a Lynx Sedona grill, refrigerator, side burner, and storage. You can already see it waiting for you.



### PATENTED KNOCK DOWN ASSEMBLY DESIGN

The Lynx Life is easy. Your Sedona Island should be, too

At Lynx, we are always innovating—so we developed and patented a unique assembly method that makes our islands quick and clear to assemble, while still ensuring that they provide solid stability and long-term durability.

With an island that's solid yet simple to build, your outdoor kitchen is waiting for you.

### PROMPT PERFECTION

The ready-to-finish island is designed to assemble in 30 minutes with two to three people.

### AFFORDABILITY

The Ready to Finish island or full packages can help create your outdoor kitchen for a third of the cost.



Each island includes a pair of Bluetooth® speakers



Each island includes a USB charging port

### UNMATCHED QUALITY

Framing made of galvanized steel and HardieBacker® board with Mold Block Technology. Each island is handcrafted and backed by a limited lifetime warranty by Lynx Grills.

## PRODUCT TECHNICAL SPECIFICATIONS



ISLAND DIMENSIONS: WIDTH: 71.75" / DEPTH: 40.625"  
GRILL DIMENSIONS: WIDTH: 29" / HEIGHT: 10" / DEPTH: 21.25"



SHIPPING DIMENSIONS: WIDTH 56" / HEIGHT 45" / DEPTH 73"  
SHIPPING WEIGHT: 859 POUNDS



GAS REQUIREMENTS: SHIPS IN LIQUID PROPANE OR NATURAL GAS FROM FACTORY



ELECTRICAL REQUIREMENTS: INSTALLATION REQUIRES AN OUTDOOR 120V/15GFI ELECTRICAL OUTLET ADJACENT TO PRODUCT



COOKING CONFIGURATION: BUILT-IN GRILL WITH 1 PROSEAR INFRARED BURNER AND 1 STAINLESS STEEL BURNER

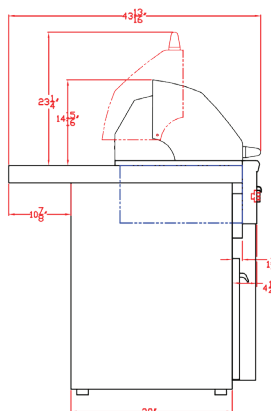

LEFT SIDE VIEW

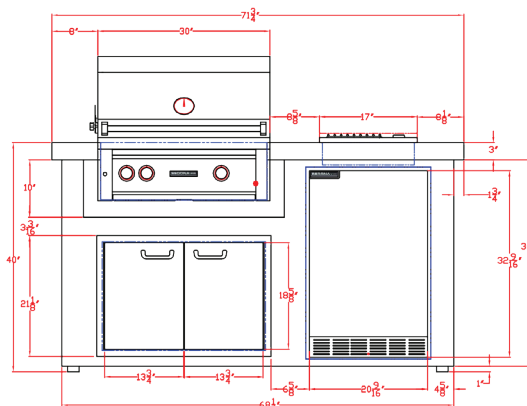

FRONT VIEW